

HS SERIES TELEPHONE - HOOK SWITCH



1. RATING : 36 V DC , 0.1 A .
2. OPERATING TEMPERATURE : -20°C ~ 70°C .
3. OPERATING FORCE : 100 gf MAX .
4. CONTACT RESISTANCE : 50 mΩ MAX .
5. INSULATION RESISTANCE : 500 V DC , 100 MΩ MIN .
6. OPERATING LIFE : 300,000 CYCLES.

HOW TO ORDER

HS	001	-	P	2	N	A	A	A
----	-----	---	---	---	---	---	---	---

SERIES	NUMBER	TERMINAL	POLE	OPERATION	CIRCUIT TYPE	FRAME TYPE	ACTUATOR TYPE
TELEPHONE -HOOK SWITCH	SERIAL No.	P = P.C.B		N = NON-LOCK			

HS001-P2NAAA

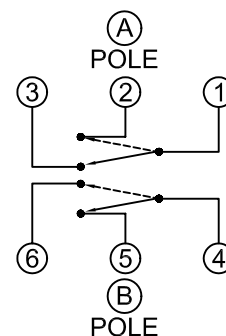
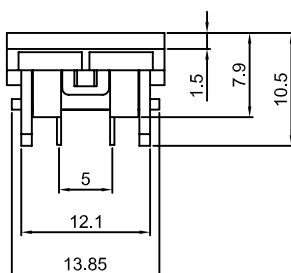
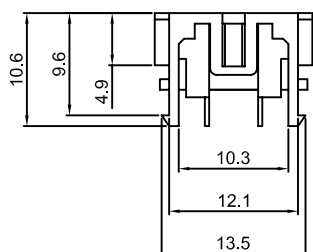
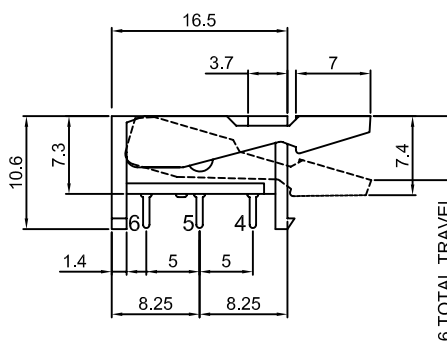
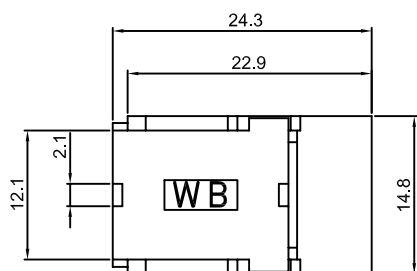

P.C.B LAYOUT

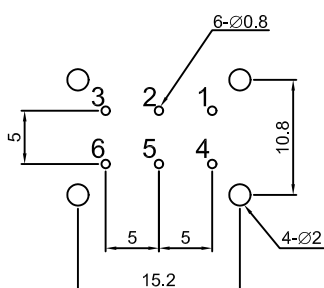

CIRCUIT

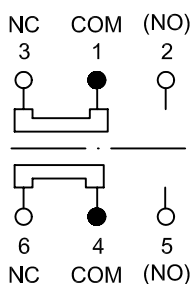

SWITCH SEQUENCE

		0	1	2	3	4	5	MM
A POLE	① ③	ON	OFF	OFF	OFF	OFF	OFF	
	① ②	OFF	OFF	ON	ON	ON	ON	
B POLE	④ ⑥	ON	OFF	OFF	OFF	OFF	OFF	
	④ ⑤	OFF	OFF	OFF	ON	ON	ON	