

IN SERIES INTERRUPTER



1. RATING : 125 V AC , 15 A .
2. CONTACT RESISTANCE : 30 mΩ MAX .
3. INSULATION RESISTANCE : 1,000 MΩ MIN .
4. OPERATING TEMPERATURE : -20°C ~ 70°C .
5. OPERATING LIFE : 6,000 CYCLES .

HOW TO ORDER

IN	001	-	L	2	1	N	A	
----	-----	---	---	---	---	---	---	--

SERIES	NUMBER	OPERATION	POLE	POSITION	CIRCUIT	FRAME TYPE	INDUCTOR RESISTANCE
INTERRUPTER	SERIAL No.	L = LOCK			N = NON-SHORTING	A = STANDARD	A = 60 Ω B = 270 Ω

IN001-L21NA □

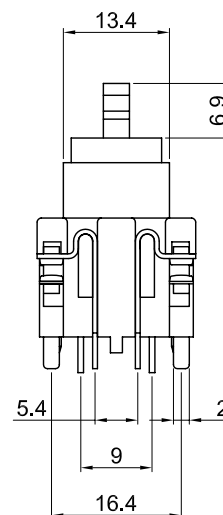
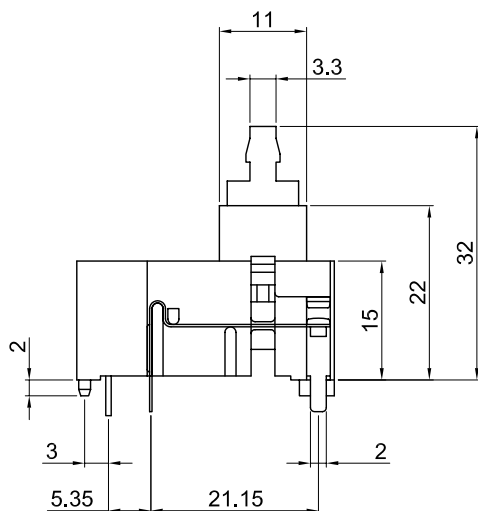
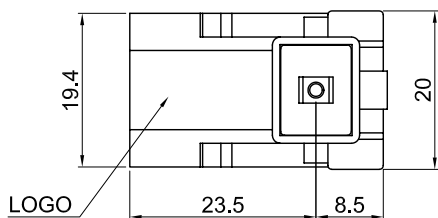

P.C.B. LAYOUT

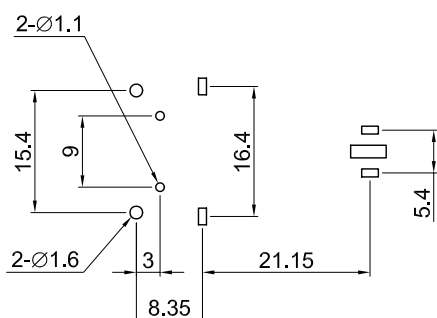

CIRCUIT

