

PS SERIES PUSH SWITCH

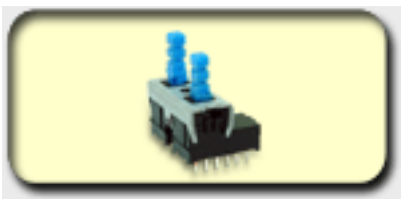

1. RATING : 30 V DC , 100 mA .
2. CONTACT RESISTANCE : 40 mΩ MAX .
3. INSULATION RESISTANCE : 500 V DC , 100 MΩ MIN .
4. OPERATING FORCE : 300 ±100 gf .
5. OPERATING LIFE : 10,000 CYCLES .

HOW TO ORDER

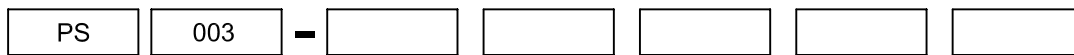

SERIES	NUMBER	OPERATION	POLE	POSITION	TIMING	FRAME TYPE
PUSH SWITCH	SERIAL No.	L = LOCK N = NON-LOCK M = MULTI-SET I = INTER-LOCK	4	2	S = SHORTING N = NON-SHORTING	S A B M or I

POLE & TYPE

PS003

4 POLE / S TYPE

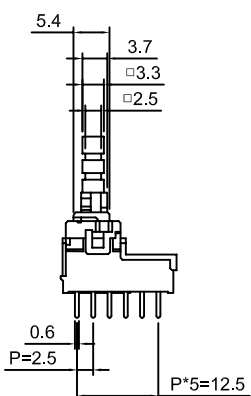
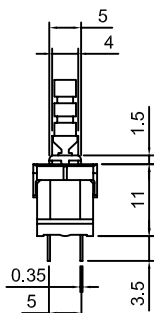

TYPE A

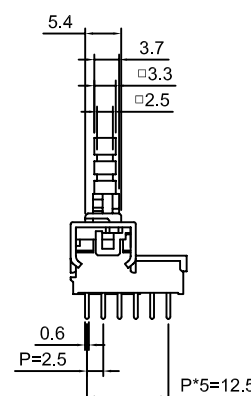
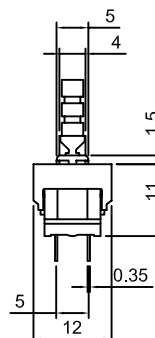

TYPE B

TYPE M or I

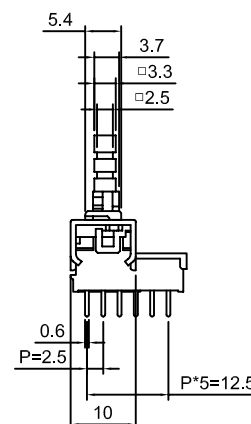
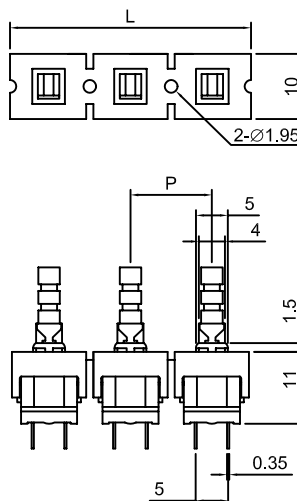
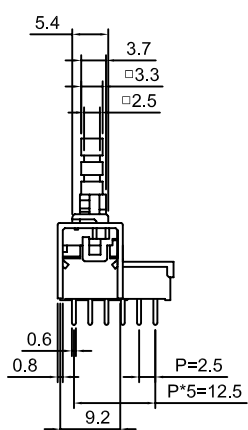
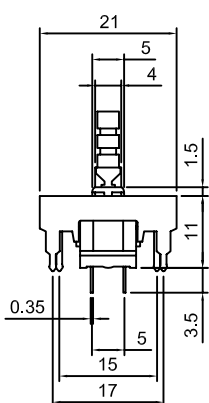

PITCH & KEY

		L					
No. of Keys		2	3	4	5	6	
P (PITCH)	A	SINGLE					
	B	12.5	27.5	40	52.5	65	77.5
	C	15	30	45	60	75	90
	D	20	35	55	75	95	115